

Multimedia Projector EMP-822 EMP-83

EPSON
EXCEED YOUR VISION



Multifunction, Reliability & Affordable Performance

2600 ANSI lm EMP-822 XGA
2200 ANSI lm EMP-83 XGA



High Performance for Your Ceiling Mount

Direct Power-ON/OFF, Easy Lamp Change, 7W High Output Speaker, Network Functionality

Direct Power-ON/OFF

It is possible to tie the projector into the room's main power source or a central controller in a room so that when you turn main power source the projector is also activated.

Easy Lamp Change

You can change the lamp easily even when ceiling mounted.



7W Speaker



The high output speaker allows you to hear clearly, even in large spaces such as a meeting room or classroom.

Network Functionality

EMP-Monitor

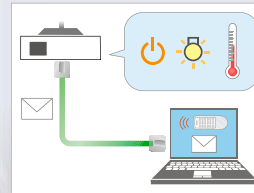

Oversee and control the state of a projector from a remote LAN connected PC. The PC acts as remote controller, allowing you to turn the power on and off, change between sources, and control and monitor the lamp and temperature conditions. This feature enables the user to deal with a problem "BEFORE" it happens, unlike other applications that notify you when a problem has occurred, after it is too late.

Peace of Mind Security and Performance with Low-Cost Usability

Tough Security Bar, Password Protect and Kensington Lock



EMP 822 and 83 have a built-in, tough security bar as a reliable countermeasure against theft. Password protection and a Kensington Lock are also built-in to give peace of mind when used in high traffic venues.

4000Hour Long-life Lamp*

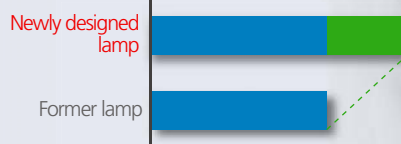

New E-TORL Lamp



The new longer lamp-life makes it an economical choice. Plus, you don't have to worry about the lamp burning out.

* In Low Brightness mode.

Low Consumption Power & Lens Cover Timer

It uses a low 231W during operation and just 5.8W when in standby.*With an environmentally conscious, energy conserving design, it will shut the power off automatically if the slide has been closed for 30 min.



Operating Power
231W*

*This numerical value is for 200-240 volt regions. Consumption is 248W and 4.1W in 100-120 volt regions.

28dB Low Fan Noise

The low 28 dB* (Low Brightness mode) fan noise is not disruptive to conversation or presentations.

* In High Brightness mode, it is 35dB.

Compact and Bright - Epson's Innovative New E-TORL Lamp

(E-TORL : Epson-Twin Optimize Reflection Lamp)

Epson's recently developed small, high performance "E-TORL" lamps efficiently gather and project light to effectively eliminate light-leakage and minimize light diffraction. This system combines an ellipsoidal reflector with an aspherical lens and a hemispherical mirror to produce a lamp so small and highly efficient that it is ahead of its time.

E-TORL

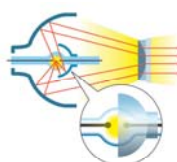

Convenient Desktop Use

- AV Mute Slide
- Instant Off
- Auto Keystone Correction +/-30°
- Quick Start-up 5sec.
- Single-Foot Release Lever

EMP-822 EMP-83

SPECIFICATIONS

		EMP-822	EMP-83	
Projection System		RGB Liquid-Crystal Shutter Projection System		
Specification of	LCD	Size 0.63 inch with MLA (x 3)	0.63 inch W/O MLA (x 3)	
Main Parts		Driving Method	Polysilicon TFT Active Matrix	
		Pixel Number	786432 dots (1024 x 768) x 3	
		Native Resolution	XGA	
Projection Lens		Manual Focus & 1.2 x Optical Zoom F=1.60-1.74 / f=18.4 - 22.1 mm		
Lamp		Type	170 W UHE	
		Life	3000 hours (High Brightness mode) / 4000 hours (Low Brightness mode)	
Screen Size (Projected Distance)		30 to 300 inch [0.9 to 10.4 m]		
Offset		8.6:1		
Brightness	High / Low Brightness Mode	2600 ANSI lm / 2080 ANSI lm	2200 ANSI lm / 1760 ANSI lm	
Contrast		400:1		
Color Reproduction		Full-Color (16.77 million colors)		
Sound Output		7 W Monaural		
Effective Scanning Frequency Range (Analog)	Pixel Clock	13.5 MHz to 162 MHz		
	Horizontal	15 KHz to 92 KHz		
	Vertical	50 Hz to 85 Hz		
Auto Keystone Correction		Vertical : -30 to +30 degrees		
Analog RGB I/O	Display Performance	Native	1024 x 768 dots (XGA)	
		Resize	UXGA / SXGA / SVGA / VGA	
	Input Terminal	Video	D-sub 15-pin x 2	
		Audio	Stereo mini-jack x 2	
Output Terminal	Video	D-sub 15-pin x 1		
	Audio	Stereo mini-jack x 1		
Video I/O	Input Signal	Video Standard	NTSC / NTSC4.43 / PAL / M-PAL / N-PAL / PAL60 / SECAM	
		Input Terminal	Video	Composite Video: RCA (Yellow) x 1 S-Video: Mini DIN Component Video: D-sub 15-pin x 2 Video-RGB: D-sub 15-pin x 2
	Audio	Serial Terminal	RCA x 2 (white / Red)	
		Serial Terminal	mini D-sub 9 pin x 1	
Control I/O	Serial I/O	LAN (RJ45) x 1		
Network I/O		LAN (RJ45) x 1		
Operating Temperature		5°C to 35°C <41°F to 95°F>		
Operating Altitude		Up to 7,500 feet <2,286 m> (over 4,921 feet <1,500 m> area: with High Altitude mode) about 5 sec.		
Start-Up Period		Instant off		
Cool-Down Period		Instant off		
Power Supply Voltage		100 - 240 VAC ±10% , 50 / 60 Hz		
Power Consumption		100 - 240 VAC 50 / 60 Hz 2.8 - 1.2 A		
Dimensions (D x W x H)		245 x 327 x 92 mm (Excludes Feet)		
Weight		Approx. 6.4 lbs. / 2.9 kg		
Fan Noise	High / Low Brightness Mode	35 dB / 28 dB		

SUPPLIED ACCESSORIES

Power Cable	3.0 m
Remote Control	With AAA type alkaline batteries x 2pcs
Computer Cable	1.8 m <6 ft>, AHD-15 pin type slim-cable
Password Protect Sticker	
Owner's Manual	

OPTIONAL ACCESSORIES

ELLP42	Spare Lamp
ELPAF13	Air Filter Set
ELPSC06	50-inch Screen
ELPSC07	60-inch Screen
ELPSC08	80-inch Screen

Bold, Bright, Beautiful...3LCD Technology

3LCD technology achieves brighter, more natural images and smoother, sharper video playback. No color break-up makes images gentler on the eyes.



3LCD projector 1-chip DLP* projector

*DLP® is a registered trademark or a trademark of Texas Instruments in the U.S. and / or other countries.

WARRANTY SERVICE

2 years International Warranty Service. Onsite Warranty Service to be provided for local purchase only.



The warranty service can be extended by purchasing EPSON COVERPLUS Extended Warranty. For more information, please contact EPSON customer support.

PROJECTION DISTANCE

EMP-822/EMP-83			
4:3 Screen size	Shortest (Wide)	Longest (Tele)	Vertical distance from center of lens to bottom edge of screen
X (screen size / dimension)	Y (cm / inch)		Z (cm / inch)
30" / 61 cm x 46 cm 24.0" x 18.1"	84 / 33	101 / 40	5 / 1.9
40" / 81 cm x 61 cm 31.9" x 24.0"	113 / 44	136 / 53	6 / 2.5
60" / 120 cm x 90 cm 47.2" x 35.4"	171 / 67	206 / 81	10 / 3.8
80" / 160 cm x 120 cm 63.0" x 47.2"	229 / 90	275 / 108	13 / 5.0
100" / 200 cm x 150 cm 78.7" x 59.1"	287 / 113	345 / 136	16 / 6.3
200" / 410 cm x 300 cm 161.4" x 118.1"	577 / 227	693 / 273	32 / 12.5
300" / 610 cm x 460 cm 240.2" x 181.1"	867 / 341	1041 / 410	48 / 18.8

CONNECTOR PANEL

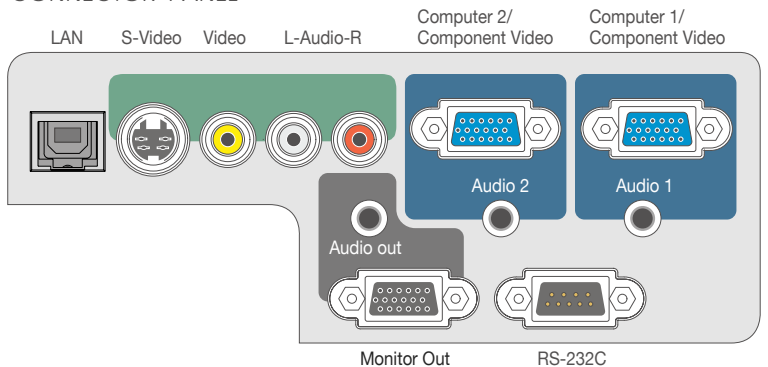

EPSON HONG KONG LIMITED

20/F., Harbour Centre,
25 Harbour Road, Wanchai, Hong Kong

EPSON Customer Service Centre
Unit 517, Trade Square, 681 Cheung Sha Wan Road,
Cheung Sha Wan, Kowloon, Hong Kong

20/F., Harbour Centre,
25 Harbour Road, Wanchai, Hong Kong

Enquiry hotline : (852) 2827 8711
Technical hotline : (852) 2827 8911

URL: www.epson.com.hk